

featuring CHARLOTTE COLLECTION BY BARI J.

X
X
X
X
X
X
X
X
X
X
X
X

RIBBON WALK



FREE PATTERN

XXXXXXXXXXXXXXXXXXXXXXXX

RIBBONWALK

FINISHED SIZE | 96" x 96"

FABRIC REQUIREMENTS

Fabric A	CTT46708	1 $\frac{3}{8}$ yd.
Fabric B	CTT36707	1 $\frac{1}{2}$ yd.
Fabric C	CTT36700	1 $\frac{1}{2}$ yd.
Fabric D	CTT36705	1 $\frac{3}{8}$ yd.
Fabric E	CTT46702	$\frac{1}{2}$ yd.
Fabric F	CTT46703	$\frac{1}{2}$ yd.
Fabric G	CTT46705	$\frac{7}{8}$ yd.
Fabric H	CTT36703	$\frac{1}{4}$ yd.
Fabric I	PE408	1 $\frac{3}{4}$ yd.
Fabric J	PE523	$\frac{1}{2}$ yd.
Fabric K	PE421	$\frac{3}{8}$ yd.
Fabric L	PE471	$\frac{1}{2}$ yd.
Fabric M	FE515	$\frac{5}{8}$ yd.
Fabric N	FE518	$\frac{5}{8}$ yd.
Fabric O	CTT36704	$\frac{1}{2}$ yd.

BACKING FABRIC

CTT36706 9 yds (Suggested)

BINDING FABRIC

Fabric **O** CTT36704 (Included)

CUTTING DIRECTIONS

$\frac{1}{4}$ " seam allowances are included.
WOF means width of fabric.

- Four (4) 12 $\frac{1}{2}$ " squares from fabric **A**.
- Two (2) 13 $\frac{3}{4}$ " squares from fabric **A**.
- Four (4) 13 $\frac{1}{2}$ " x 7 $\frac{1}{2}$ " squares from fabric **A**.
- Two (2) 24 $\frac{7}{8}$ " squares from fabric **B**.
- Two (2) 24 $\frac{7}{8}$ " squares from fabric **C**.
- Six (6) 13 $\frac{3}{4}$ " squares from fabric **D**.
- Four (4) 13 $\frac{1}{2}$ " x 7 $\frac{1}{2}$ " rectangles from fabric **D**.
- Two (2) 6 $\frac{7}{8}$ " squares from fabric **D**.
- One (1) 13 $\frac{3}{4}$ " square from fabric **E**.
- Three (3) 13 $\frac{3}{4}$ " squares from fabric **F**. (Make sure to use part of both selvages to be able to fit the 3 squares)
- Two (2) 13 $\frac{3}{4}$ " squares from fabric **G**.
- Two (2) 6 $\frac{7}{8}$ " squares from fabric **G**.
- Four (4) 13 $\frac{1}{2}$ " x 7 $\frac{1}{2}$ " rectangles from fabric **G**.
- Two (2) 6 $\frac{7}{8}$ " squares from fabric **H**.
- Two (2) 13 $\frac{3}{4}$ " squares from fabric **I**.
- Four (4) 13 $\frac{1}{2}$ " x 7 $\frac{1}{2}$ " rectangles from fabric **I**.
- Sixteen (16) 12 $\frac{1}{2}$ " x 6 $\frac{1}{2}$ " rectangles from fabric **I**.
- Eight (8) 6 $\frac{1}{2}$ " squares from fabric **I**.
- Four (4) 13 $\frac{1}{2}$ " x 7 $\frac{1}{2}$ " rectangles from fabric **J**.
- Four (4) 8 $\frac{1}{2}$ " squares from fabric **K**.
- Two (2) 13 $\frac{1}{2}$ " x 7 $\frac{1}{2}$ " rectangles from fabric **L**.
- Two (2) 6 $\frac{7}{8}$ " squares from fabric **L**.
- Four (4) 6 $\frac{1}{2}$ " squares from fabric **L**.
- Three (3) 13 $\frac{3}{4}$ " squares from fabric **M**.
- Two (2) 13 $\frac{1}{2}$ " x 7 $\frac{1}{2}$ " rectangles from fabric **M**.
- One (1) 13 $\frac{3}{4}$ " squares from fabric **N**.
- Twelve (12) 6 $\frac{1}{2}$ " squares from fabric **N**.
- Ten (10) 1 $\frac{1}{2}$ " x WOF strips from fabric **O**. (Binding)

CONSTRUCTION

Sew all rights sides together with 1/4" seam allowance.

Magic 8 method:

- Start by placing one 13³/₄" square from fabric **E** and **I** right sides together.
- Mark a diagonal line across both diagonals on the wrong side of the top fabric square.
- Sew a 1/4" scant seam on both sides of the marked diagonal lines.
- Using your rotary blade or scissors cut the square into eighths as pictured above #3.
- You will cut a horizontal line, vertical line, and on both drawn diagonal lines.
- Open the blocks outward and lightly press. Be very careful to only press up and down, NOT back and forth so as not to stretch them. Your seam should be pressed (both layers) toward the darker color.
- Trim each HST to a 6¹/₂" square.

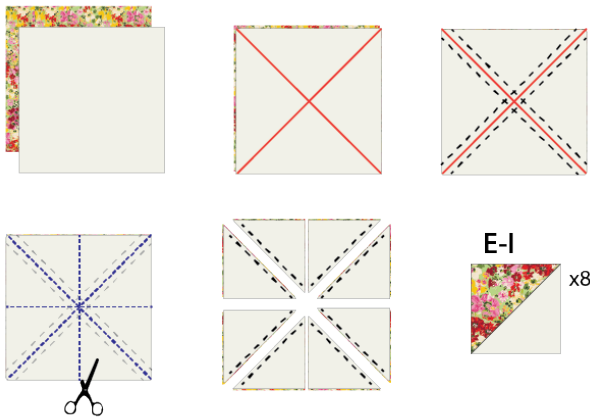

DIAGRAM 1

- Repeat the Magic 8 technique with two (2) 13³/₄" squares from fabrics **D** and **F**. Make a total of sixteen (16) **D-F** HST. Trim each piece to 6¹/₂" square.

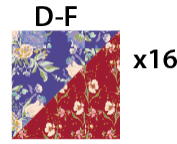

DIAGRAM 2

- Repeat the Magic 8 technique with three (3) 13³/₄" squares from fabrics **D** and **M**. Make a total of twenty four (24) **D-M** HST. Trim each piece to 6¹/₂" square.

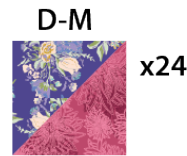

DIAGRAM 3

- Repeat the Magic 8 technique with one (1) 13³/₄" square from fabrics **F** and **N**. Make a total of eight (8) **F-N** HST. Trim each piece to 6¹/₂" square.

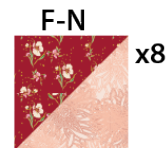

DIAGRAM 4

- Repeat the Magic 8 technique with one (1) 13³/₄" square from fabrics **D** and **I**. Make a total of eight (8) **D-I** HST. Trim each piece to 6¹/₂" square.



DIAGRAM 5

- Repeat the Magic 8 technique with two (2) 13³/₄" squares from fabrics **G** and **A**. Make a total of sixteen (16) **G-A** HST. Trim each piece to 6¹/₂" square.



DIAGRAM 6

